



PROSCAFF ENTERPRISES INC.

COLUMN HUNG SYSTEM - BUILD FASTER. REDUCE LABOUR COSTS.

INTRODUCTION

The Proscaff Column Hung System is saving time and money allowing you to create large tables – typically 30 ft wide by 80 feet long – using a reduced number of components.

The system is highly efficient in applications with regular floor design, bay sizes and large spans between the columns. Table sizes are adjustable and the assembly can be done by a small crew of workers.

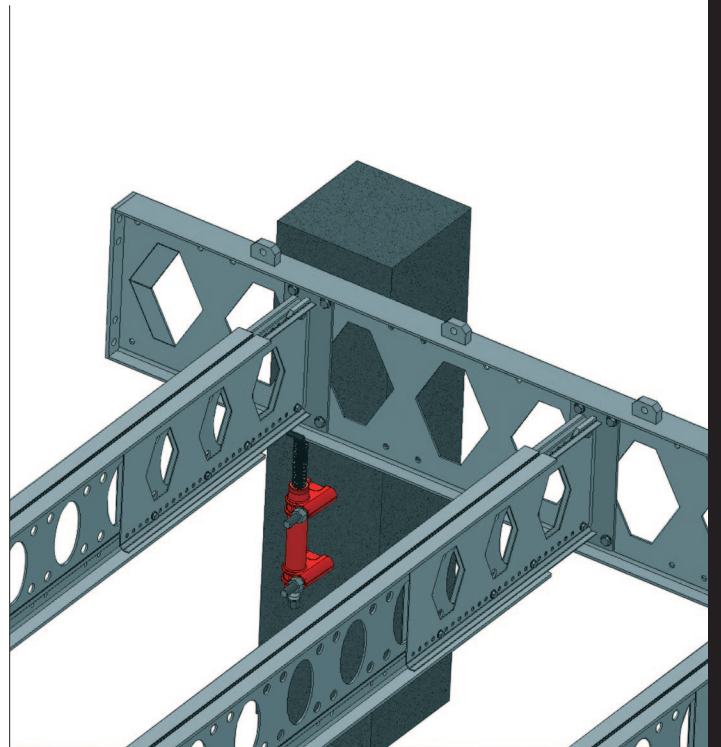

Features

The transverse beams are adjustable and various dimensions of the main beams are used.

The system reduces labor and cycle time.

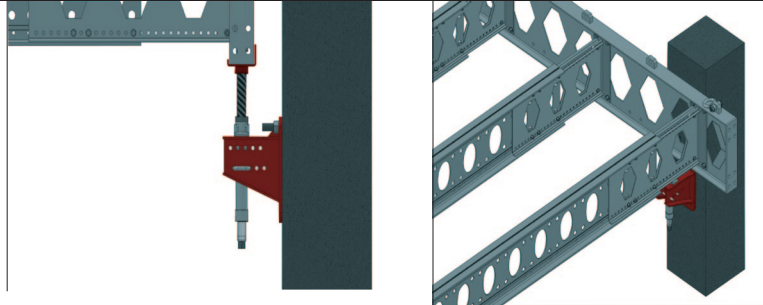

Main Components

CASTELLATED BEAM

Main beam, made of steel with a light weight design for its load carrying capacity. The hooks for lifting lugs are a design add-on, further increasing the handling speed during construction.

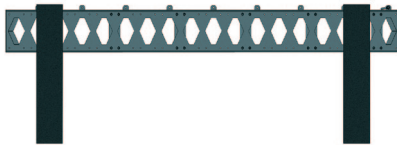

TRANSVERSE BEAM

Made of aluminum for easier handling. A steel version is available.

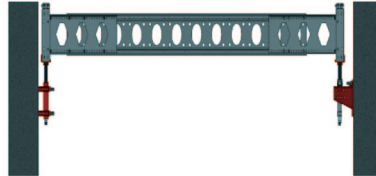

Note: The Aluminum version is showed in the models of this brochure.

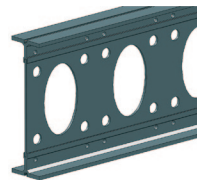

JACK BASE ASSEMBLY

This can be made available in two configurations, connected straight to the column or using a base that connects to the wall first resulting in a lighter jack.

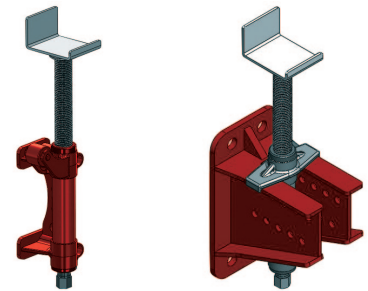

There are two configurations of jack available:

One Piece Jack:
lighter and cost effective.

Separate Jack & Base:
More versatile and faster adjustment on site

Re-shoring is unnecessary. The load is transferred, through the jack, to the column structure, rather to the floor below. Any additional work can start a few days after pouring.